

# How To Test If A Drink Is Level 3 Moderately Thick

For VIDEO instructions go to [www.viscgo.com/video-instructions](http://www.viscgo.com/video-instructions)

Please read all of these instructions before using the Yellow Level 3 Viscgo Drink Thickness Test Sticks.

## Contents

The Viscgo Yellow Level 3 Test consists of one Yellow Level 3 Stick which tests if a drink is too thin for Level 3 Moderately Thick.



There is no Viscgo Stick to test if a drink is too thick for Level 3 because if a drink is too thick to pour and has to be consumed with a spoon, it is too thick.

## Intended use

To test if a drink thickened with xanthan gum-based thickener is Level 3 Moderately Thick. Not intended to test drinks thickened with starch-based thickener.

## Intended user

Anyone who uses xanthan gum-based thickener to thicken drinks to Level 3 Moderately Thick.

## Preparation

Wash the stick before first use.

Before each use, check the stick is clean and not bent or damaged in any way and the black print is clearly visible.

The stick must be used the right way up as shown below:

The blunt end should be at the top.



3

Viscgo



- ← Number should be the right way up.
- ← Viscgo logo should be above the depth mark.

The pointed end should be at the bottom.



Make sure the cup containing the drink is on a flat, level surface, not at an angle, and is not vibrated or knocked during testing. It is easier to use a cup with a flat bottom than a curved bottom. We recommend using the [Viscgo Cup](#) as it has a flat bottom.

The drink must be between 6.5cm and 7.5cm deep. The Stick has a depth mark as a guide. We recommend using the Viscgo Cup to ensure that a 200ml drink is the correct depth for testing with the stick.

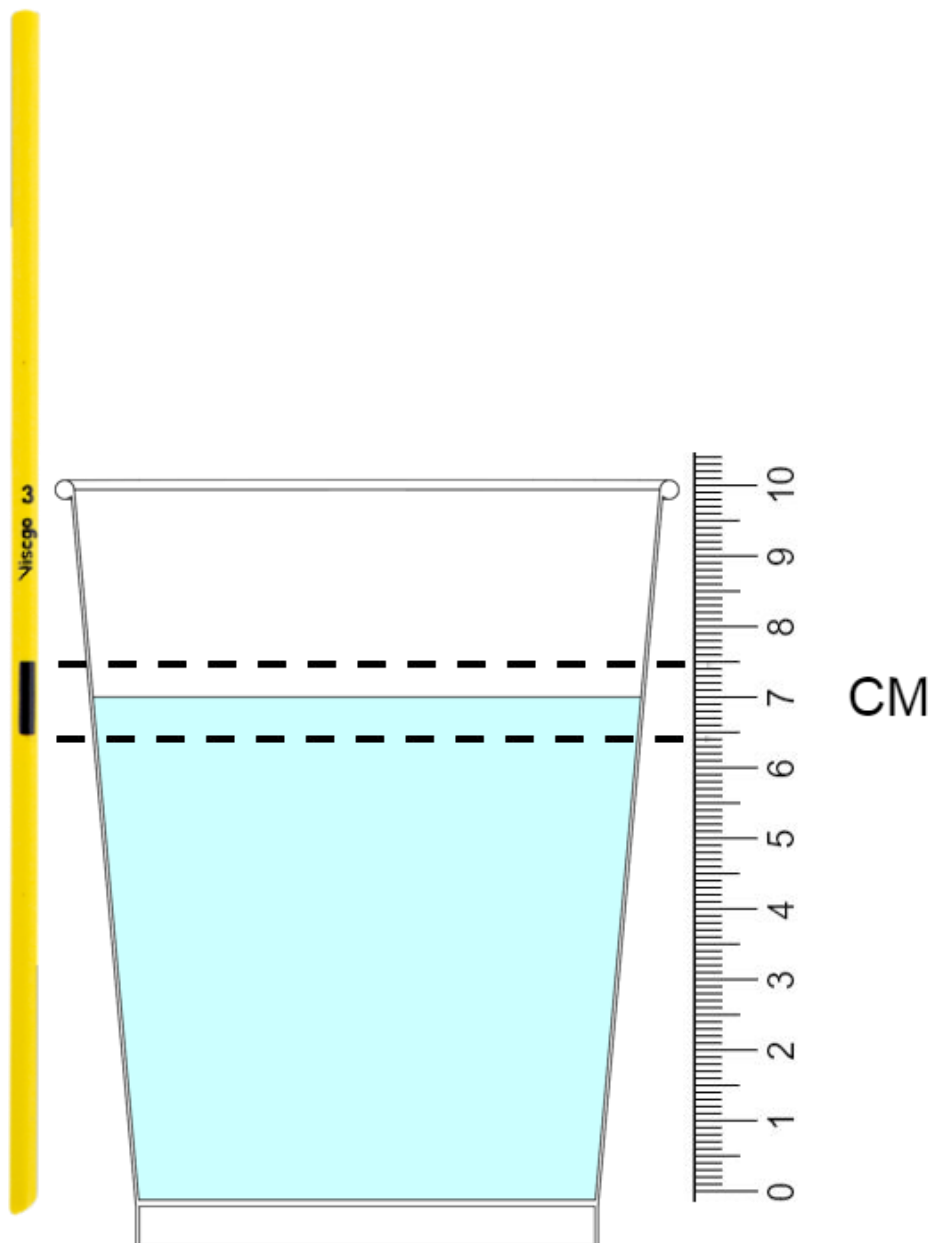

## How to test if a drink is Level 3 Moderately Thick

Hold the stick the right way up and use it to give the drink a quick vigorous stir.

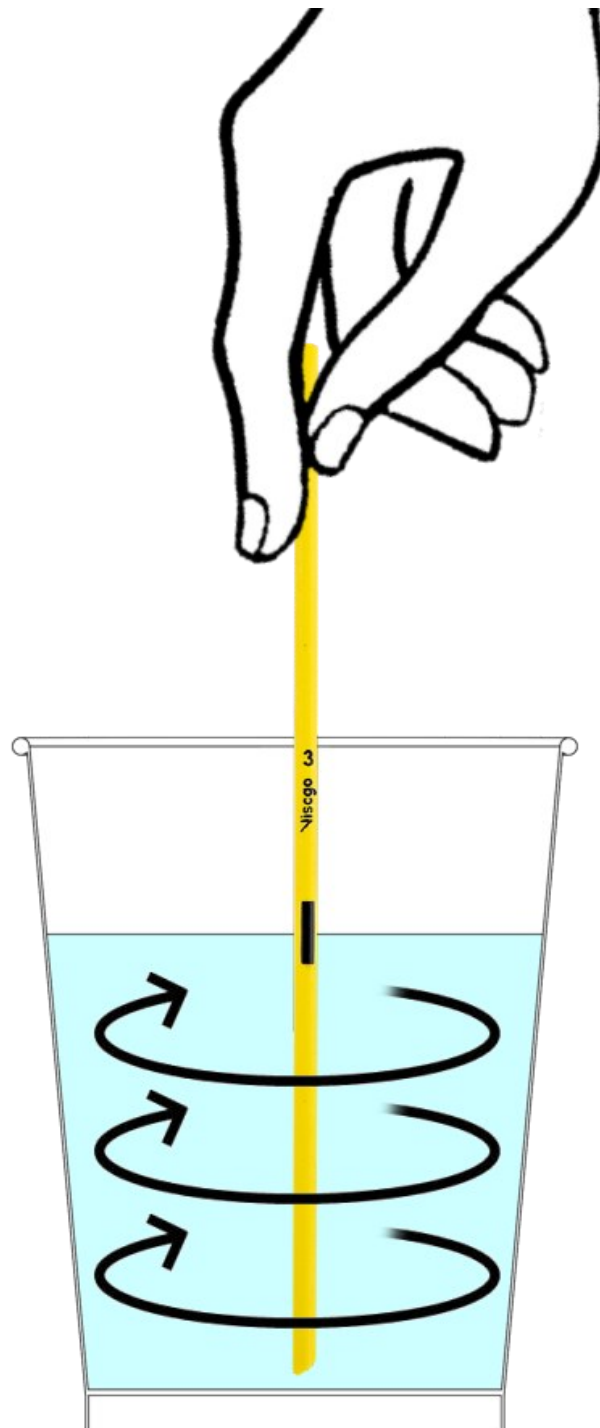

After stirring, remove the stick from the drink and then re-insert it in the drink vertically. This is because it is better to insert the stick in the drink vertically rather than move it to a vertical position within the drink.

Stand the stick in the drink, near the middle of the cup with the pointed

end touching the bottom of the cup. Hold the stick in place with your finger tip and make sure it is vertically upright, not at an angle.

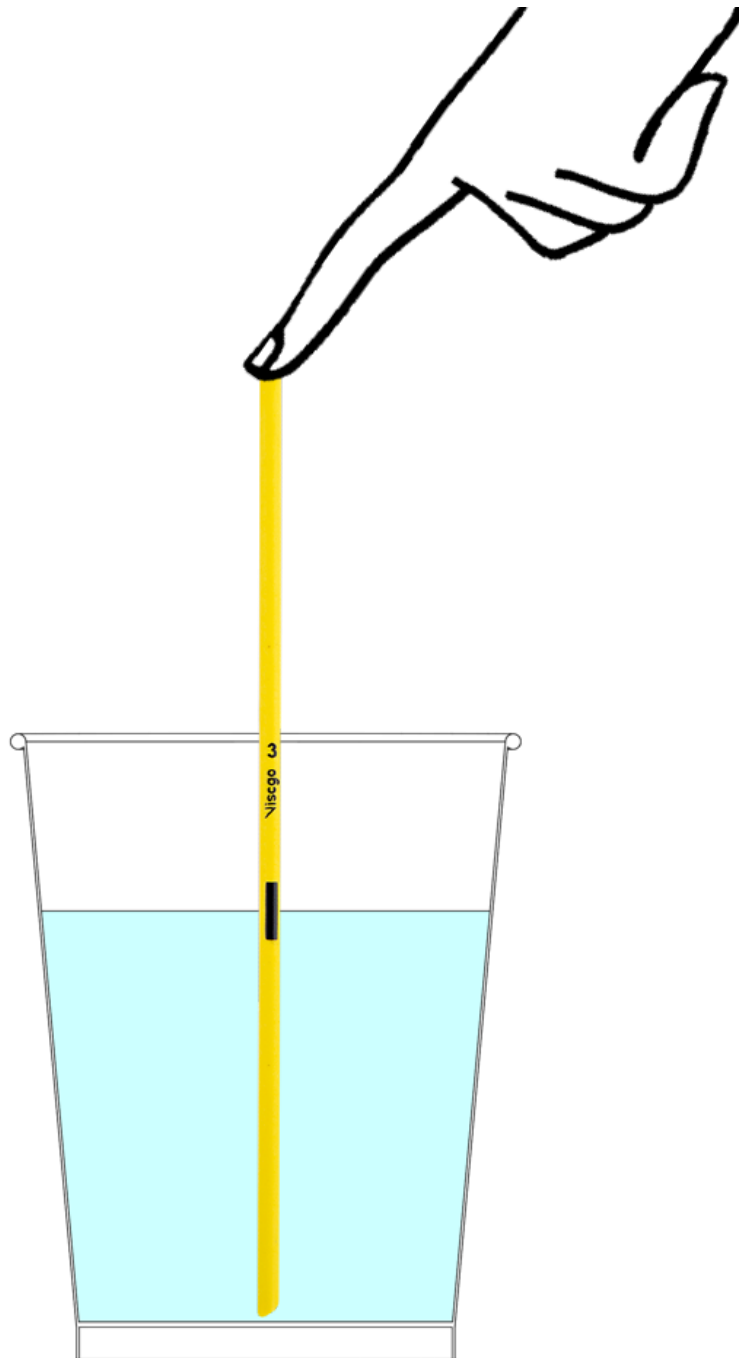

To get a correct result, it is very important to release the stick from a vertical position. Failure to do so can cause an incorrect result as the stick might fall more quickly than it would if starting from a vertical position.

Let go of the stick and wait ten seconds.

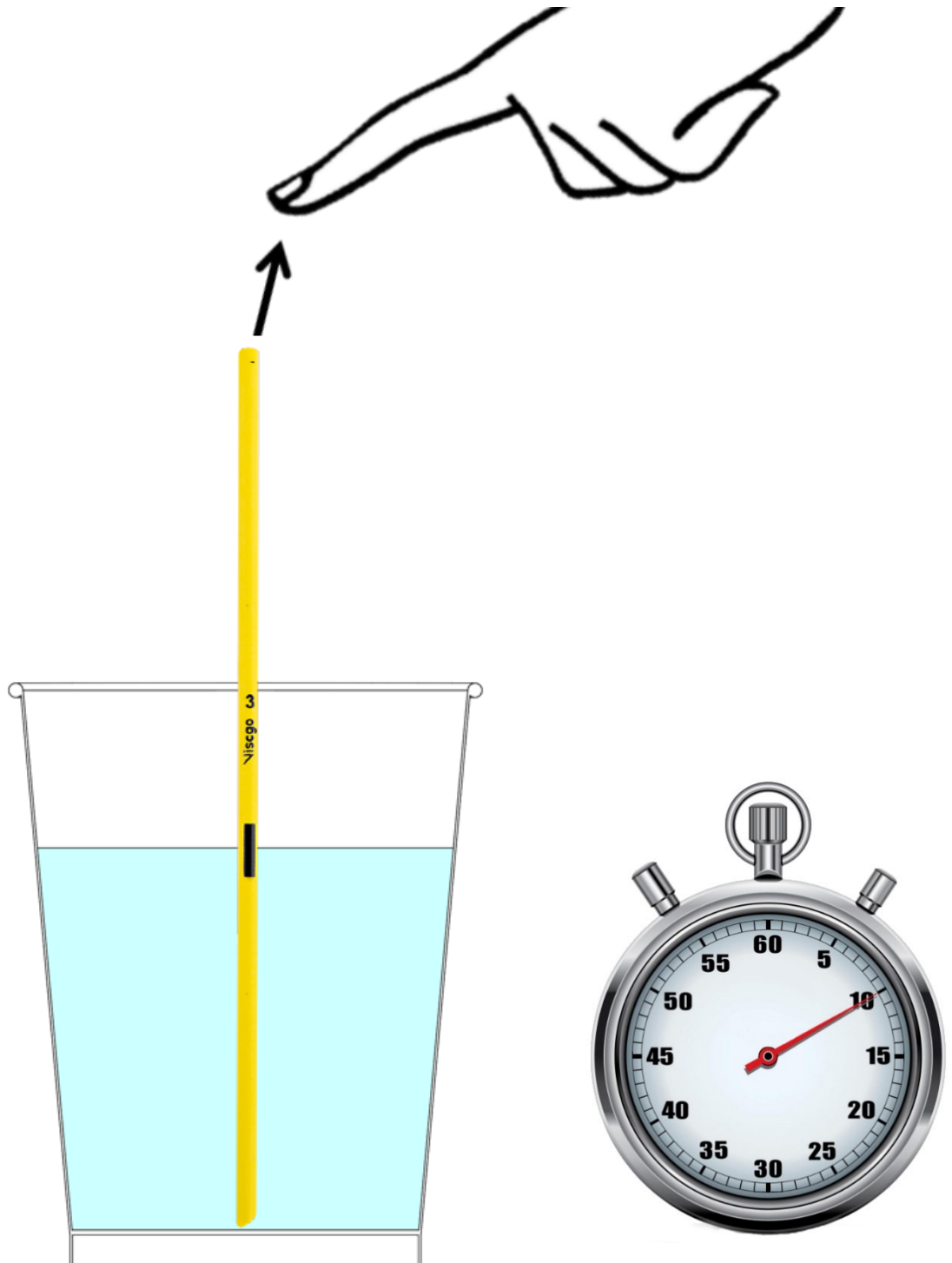

## TOO THIN

If the stick falls to the side of the cup within ten seconds the drink is TOO THIN for Level 3 Moderately Thick.

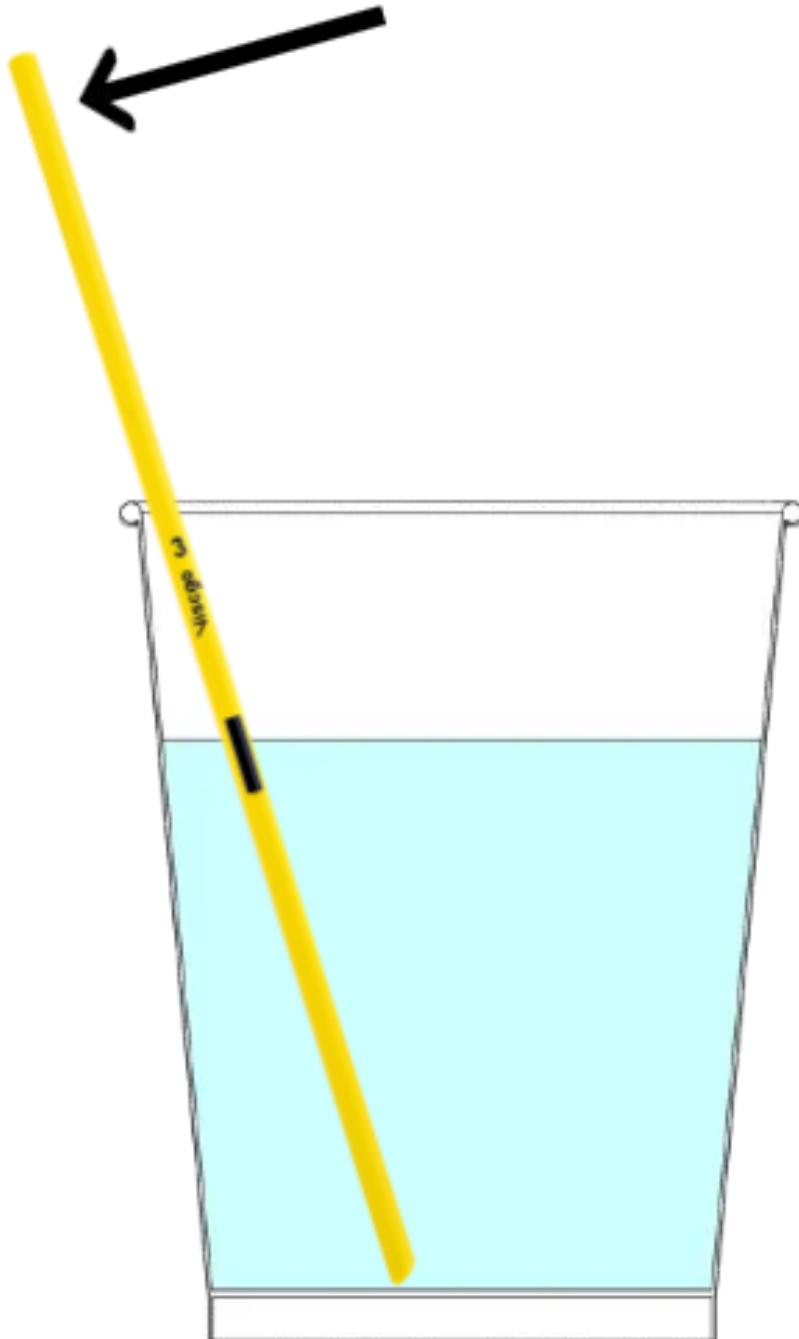

## CORRECT THICKNESS

If the stick STANDS for ten seconds, or starts to fall but doesn't reach the side of the cup within 10 seconds, AND the drink is thin enough to pour, it is the CORRECT THICKNESS for Level 3 Moderately Thick.

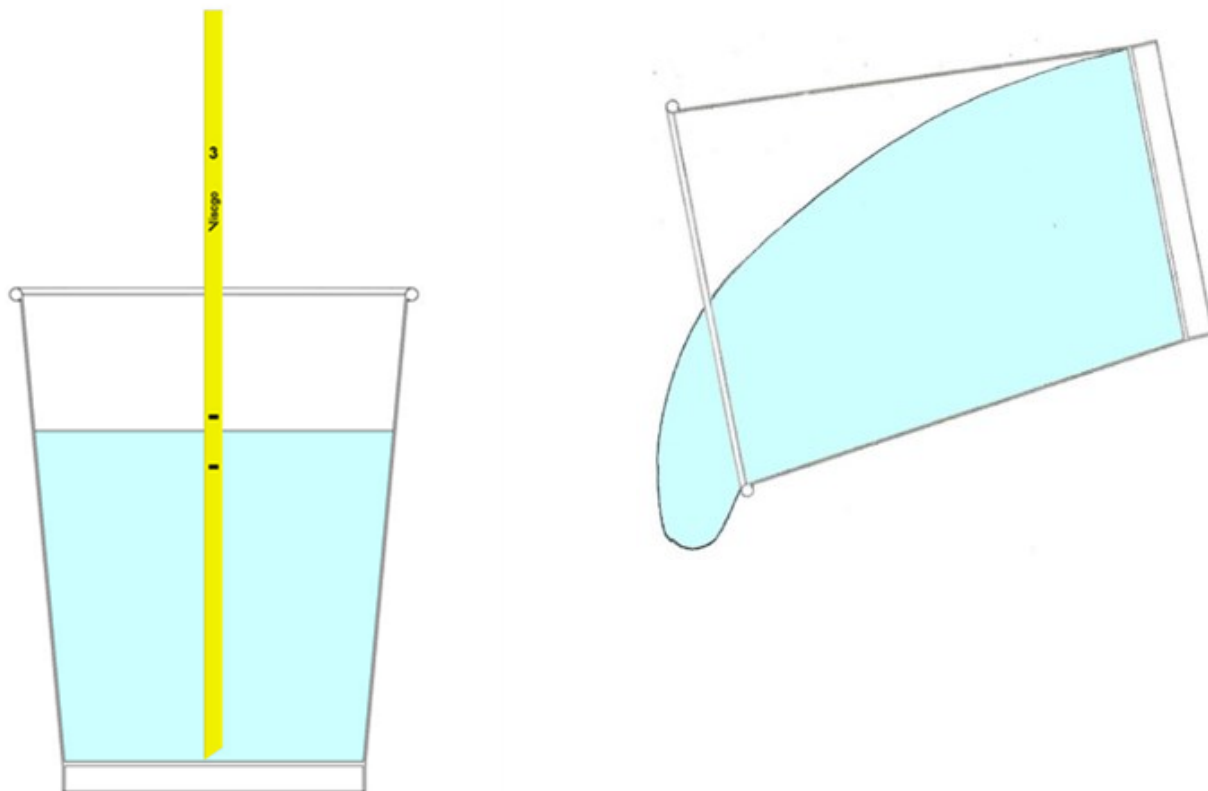

## TOO THICK

If the drink is too thick to pour, it is TOO THICK for Level 3 Moderately Thick.

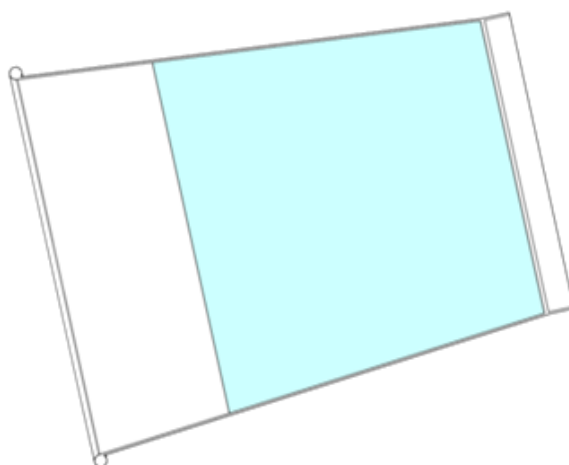



If an unexpected result occurs, for instance the stick falls quicker than expected, it is recommended to perform the test again making sure the stick starts from a vertical position.

Remove stick from the drink after ten seconds as stick will eventually fall if left in the drink longer, implying an incorrect test result.

As the consistency of thickened drinks can alter over time, for example if a hot drink cools down or a cold drink warms up, you can re-test the drink at any time using this method.

## **Warnings**

Do not use Viscgo Sticks if they are bent or damaged in any way or if the print is not clearly visible.

**CHOKING HAZARD:** keep the sticks out of reach of young children.

Avoid contact with eyes, ears, nose and mouth.

Do not use the Yellow Viscgo Stick to test if drinks are any Level other than Level 3 Moderately Thick.

The cup containing the drink must be on a flat, level surface, not at an angle.

Avoid vibrating or knocking the cup during testing.

The stick must be placed vertically upright near the middle of the drink, the right way up with the pointed end touching the bottom of the cup.

Depth of drink to be tested must be between 6.5cm and 7.5cm. There is a depth mark on the stick as a guide.

Remove the stick from the drink after ten seconds as it will eventually fall if left in a drink longer, implying an incorrect test result.

Remove the stick from the cup before serving.

## **Maintenance**

The stick can be hand washed or washed in a dishwasher. Avoid bending the stick during washing.

## **Disposal**

If the stick is bent or damaged in any way, or if the print is not clearly

visible, dispose of in general waste.

## **Notice**

Any serious incident that has occurred in relation to Viscgo sticks should be reported to the manufacturer and the competent authority of the Member State in which the user is established.

## **Manufacturer**

Viscgo Limited

Unit 21 Greenheys, Manchester Science Park, Manchester, M15 6JJ, UK  
enquiries@viscgo.com

[www.viscgo.com](http://www.viscgo.com)



LEVEL 3 IFU LARGE v4 17.10.22